

Ideas & Outlook

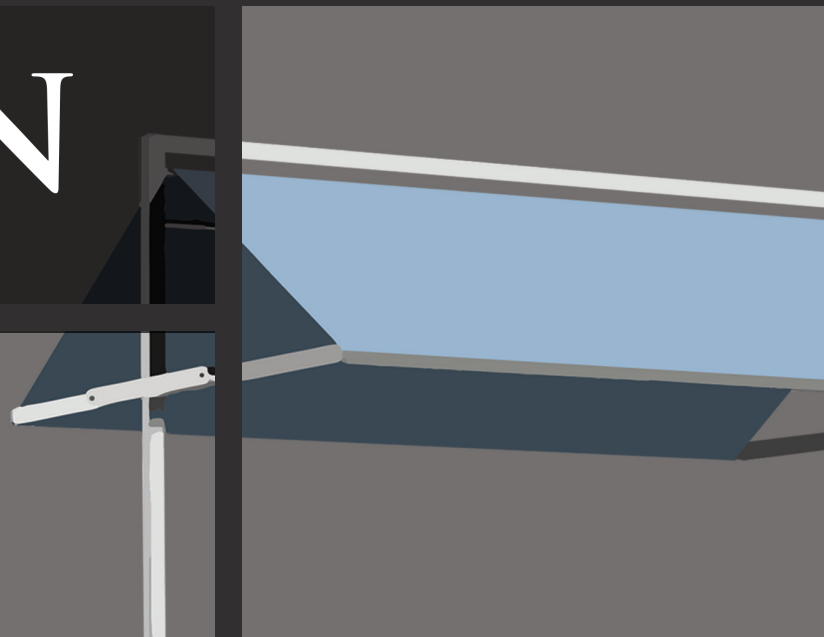

# EASTERN

TABLETOP



# THE Buffet

EXPERIENCE



# TREASURE TROVE

## Multipurpose Station

MODEL #ST9600

Closed: 35 1/2" x 35 1/2" x 78 3/4"

Open: 27 1/2" x 70 7/8" x 78 3/4"

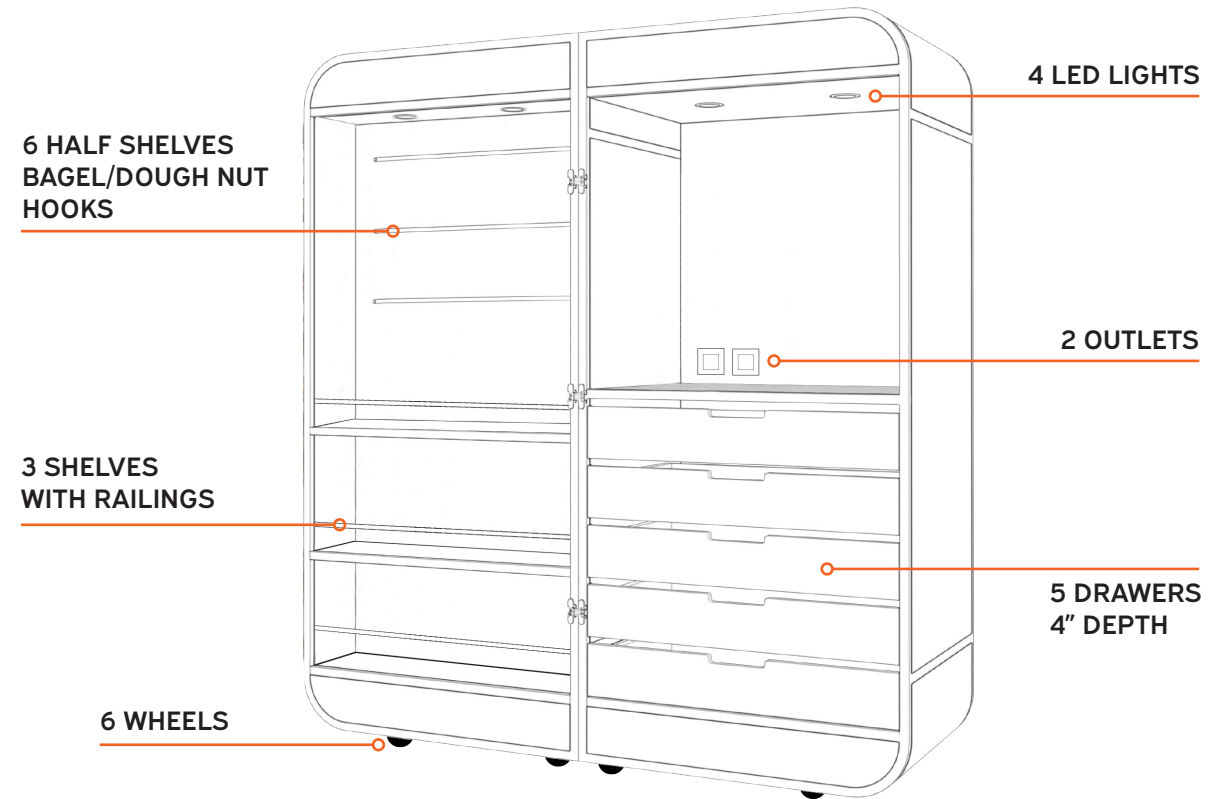

Panels & Frame are available in a wide variety of finishes and XYLO color options.



# THE ARCH

## Display Stand



**MODEL #ST4330**  
41" x 23" x 78 3/4"  
Stainless Steel, 5 Levels



**MODEL #ST4320**  
37" x 23" x 67 1/2"  
Stainless Steel, 4 Levels



**MODEL #ST4310**  
37" x 23" x 64 1/2"  
Stainless Steel, 4 Levels

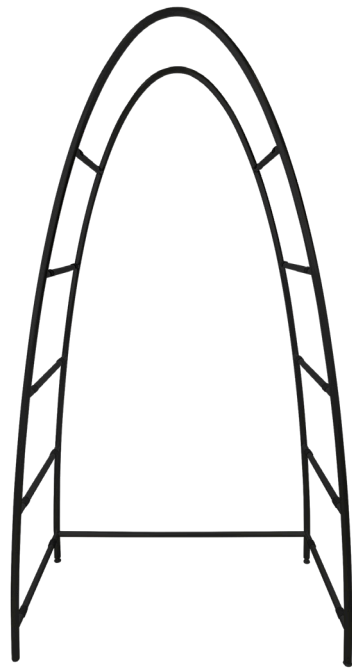

**MODEL #ST4330MB**  
41" x 23" x 78 3/4"  
Black, 5 Levels

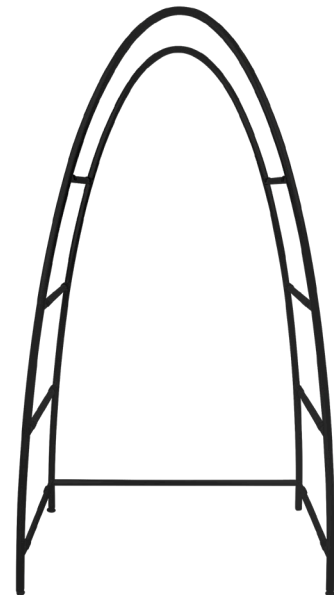

**MODEL #ST4320MB**  
37" x 23" x 67 1/2"  
Black, 4 Levels

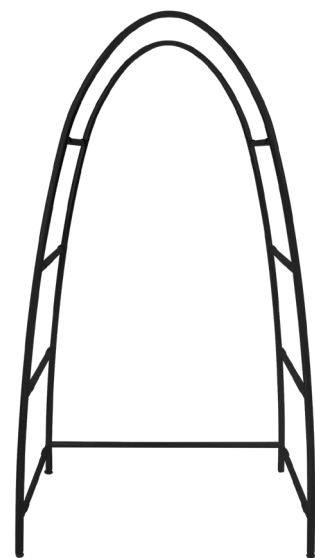

**MODEL #ST4310MB**  
37" x 23" x 64 1/2"  
Black, 4 Levels



# THE ARCH

## Display Stand

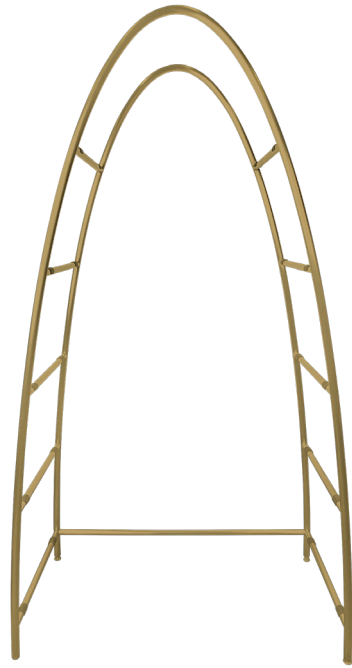

**MODEL #ST4330RZ**  
41" x 23" x 78 3/4"  
Bronze, 5 Levels

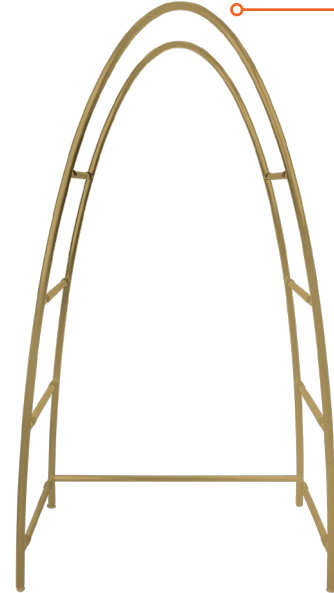

**MODEL #ST4320RZ**  
37" x 23" x 67 1/2"  
Bronze, 4 Levels

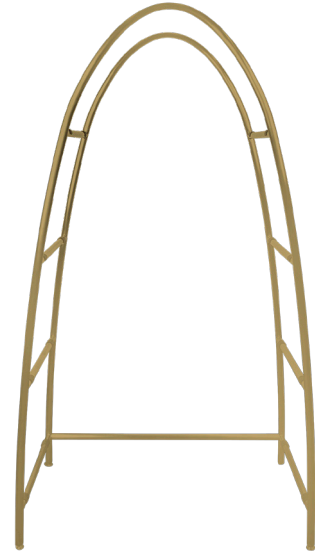

**MODEL #ST4310RZ**  
37" x 23" x 64 1/2"  
Bronze, 4 Levels

XYLO POWDER  
COATING  
AVAILABLE

SOLID ONE PIECE  
CONSTRUCTION

SHELVES  
SELF-STORE  
WITHIN UNIT

NESTS FOR  
STORAGE

SHELVES  
PROTECTED WITH  
STAINLESS STEEL  
EDGING

**MODEL #ST4300**

SET OF 3 STAINLESS STEEL,  
NESTING DISPLAYS, 4 OR 5 LEVELS,  
SHELVES IN WOOD LAMINATE WITH  
STAINLESS STEEL-EDGE ROUND CORNERS.

SET OF 3 EXTENDS FROM 3' TO 15' OF DISPLAY.

**MODEL #ST4300MB** | Black  
**MODEL #ST4300RZ** | Bronze

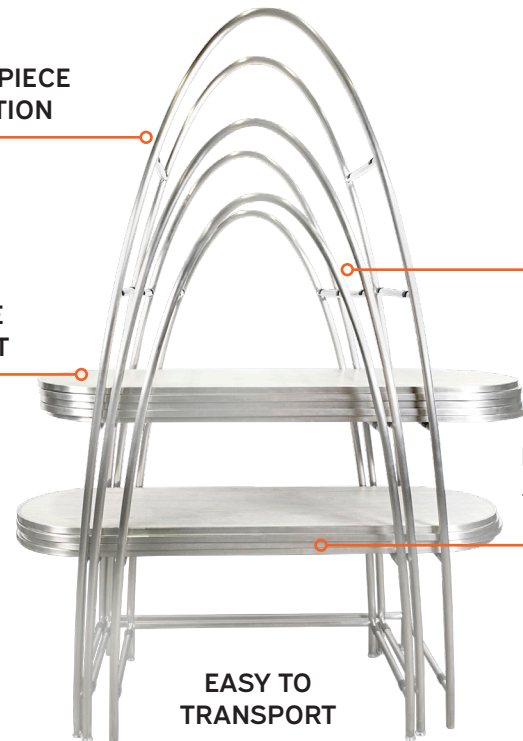

EASY TO  
TRANSPORT



# BUGGY CART

## Mobile Display

MODEL #BC6800  
BUGGY CART

MODEL #BC6820  
BUGGY CART + CANOPY  
+ ICE CREAM TILES

70 7/8" x 31 1/2" x 33 1/2"  
Height with canopy: 82 5/8"

CANOPY EASILY SLIDES  
ONTO FRAME AND FOLDS  
FOR STORAGE

INDOOR OR OUTDOOR USE

INTERCHANGEABLE  
TILES

ALL TERRAIN WHEELS

LOCKING CASTERS



The Buggy: Where every  
occasion is a smooth ride.

**Corporate Headquarters, Showroom & Warehouse:**

Eastern Tabletop Manufacturing Company Inc.  
50 Ingham Avenue  
Bayonne NJ 07002

**Telephone:**

1-718-240-9595

**Toll Free:**

1-888-422-4142

**Email:**

[sales@easterntabletop.com](mailto:sales@easterntabletop.com)

Visit [www.EasternTableTop.com](http://www.EasternTableTop.com) for full product details.

**EASTERN**  
TABLETOP

# EASTERN

TABLETOP

